



LUND  
UNIVERSITY

# Application of Health Metrics in a Cross-sector Software Ecosystem

---

JOHAN LINÅKER, PHD



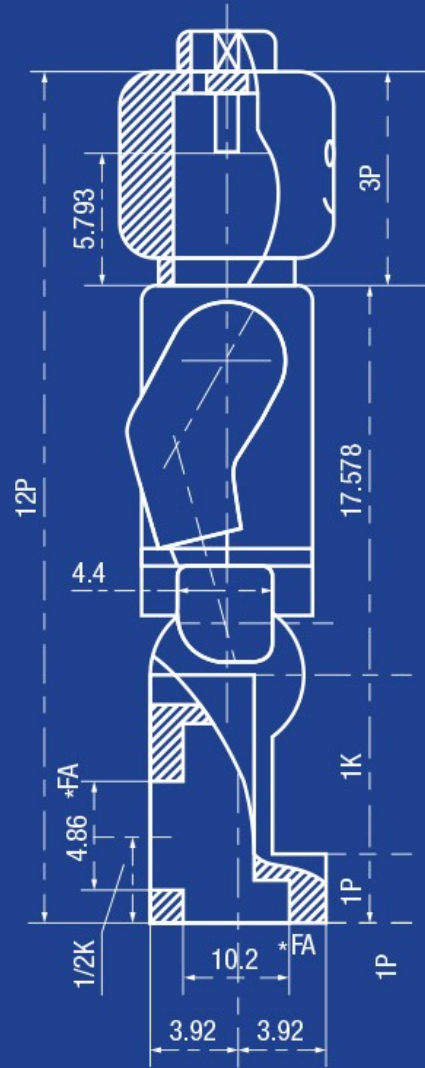
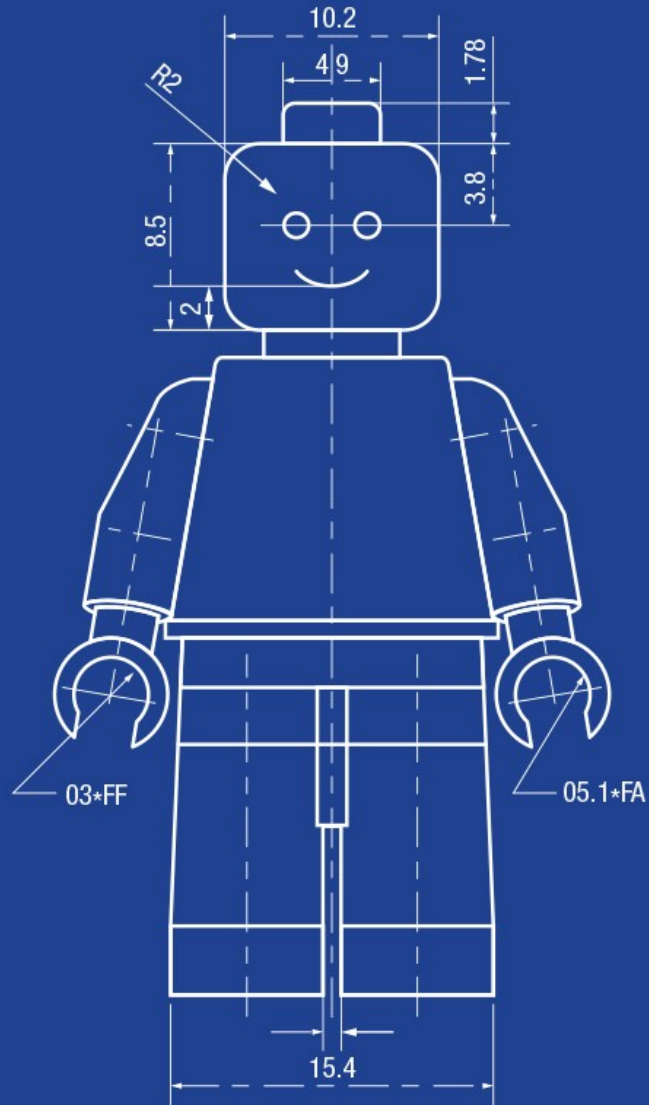

# About Johan

What do I mean by ecosystem?

# Metaphor from Biology





# Android's ecosystem



Google

VISMA

ReachMee

LinkedIn

ASSESSIO



JobTech Development Extensions  
(Open Gov Data and Open Source Software)



1011  
001



JobTech Dev



Google

VISMA

ReachMee

LinkedIn

ASSESSIO



JobTech Development Extensions  
(Open Gov Data and Open Source Software)



1011  
001



JobTech Dev

JobTech Taxonomy



Google

VISMA

ReachMee

LinkedIn

ASSESSIO



JobTech Development Extensions  
(Open Gov Data and Open Source Software)

# JobTech Dev

JobTech Jobs

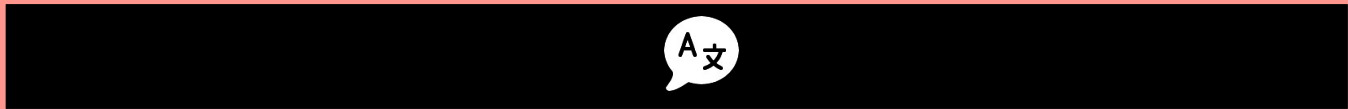



# JobTech Dev



Google

VISMA

ReachMee

LinkedIn

ASSESSIO



JobTech Development Extensions  
(Open Gov Data and Open Source Software)



1011  
001

JobTech MyData





Google

VISMA

ReachMee

LinkedIn

ASSESSIO



JobTech Development Extensions  
(Open Gov Data and Open Source Software)

# JobTech Dev

JobTech Search

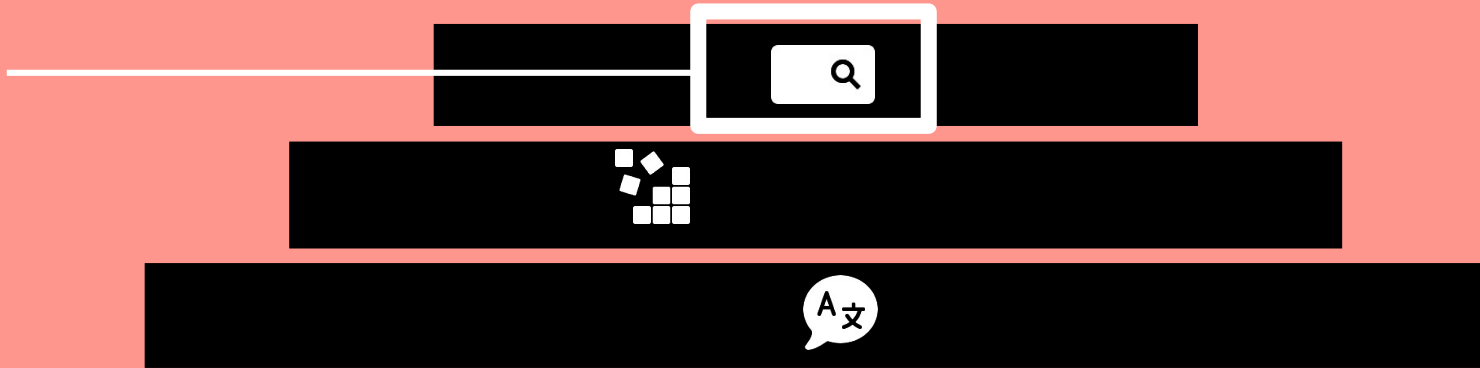



Google

VISMA

ReachMee

LinkedIn

ASSESSIO



# JobTech Dev

JobTech Development Extensions  
(Open Gov Data and Open Source Software)



1011  
001



# JobTech Dev



JobTech Development Extensions  
(Open Gov Data and Open Source Software)





Ecosystem health



- Productivity
  - ecosystem's ability to create new functionality based on the input of materials.
- Robustness
  - ecosystem's ability to survive shocks and disruptions.
- Niche creation
  - ecosystem's ability to attract a diversity of actors focused on different niches in terms of their value creation.



- Goal logic for health metrics
  - Decrease unemployment
  - Improve digital match-making and guidance
  - Enable actors in the JobTech space improve services
  - Create opportunities through a healthy JobTech Dev ecosystem and platform
  - Improve Productivity, Robustness, and Niche Creation aspects

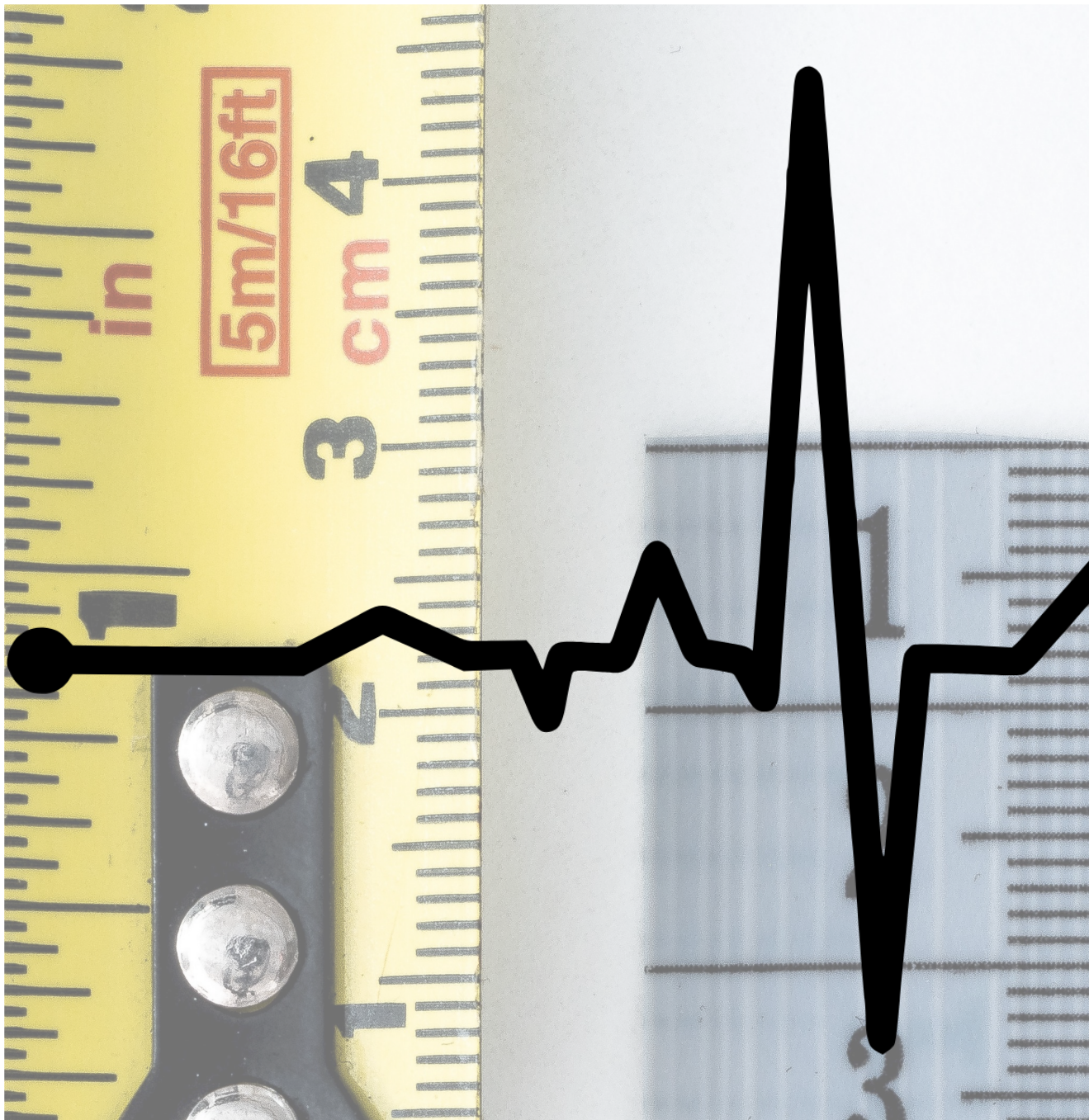

- Productivity
  - Actors
    - E.g., Visitors, API-keys
  - Interactions
    - Activity on ticket, support and communication channels
  - Contributions
    - Knowledge, data and technical
  - Application
    - New applications of data



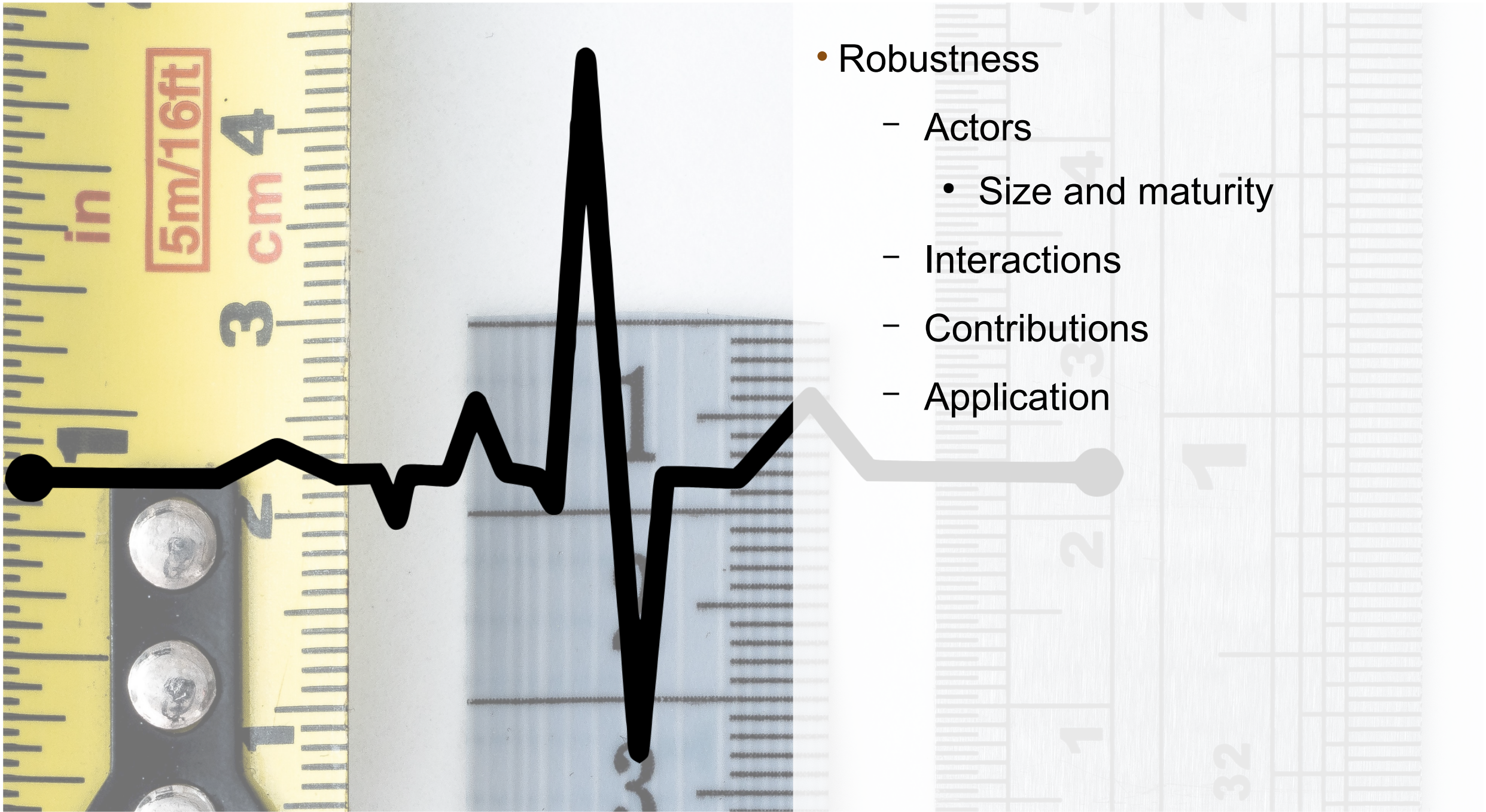

- Robustness
  - Actors
    - Size and maturity
  - Interactions
  - Contributions
  - Application

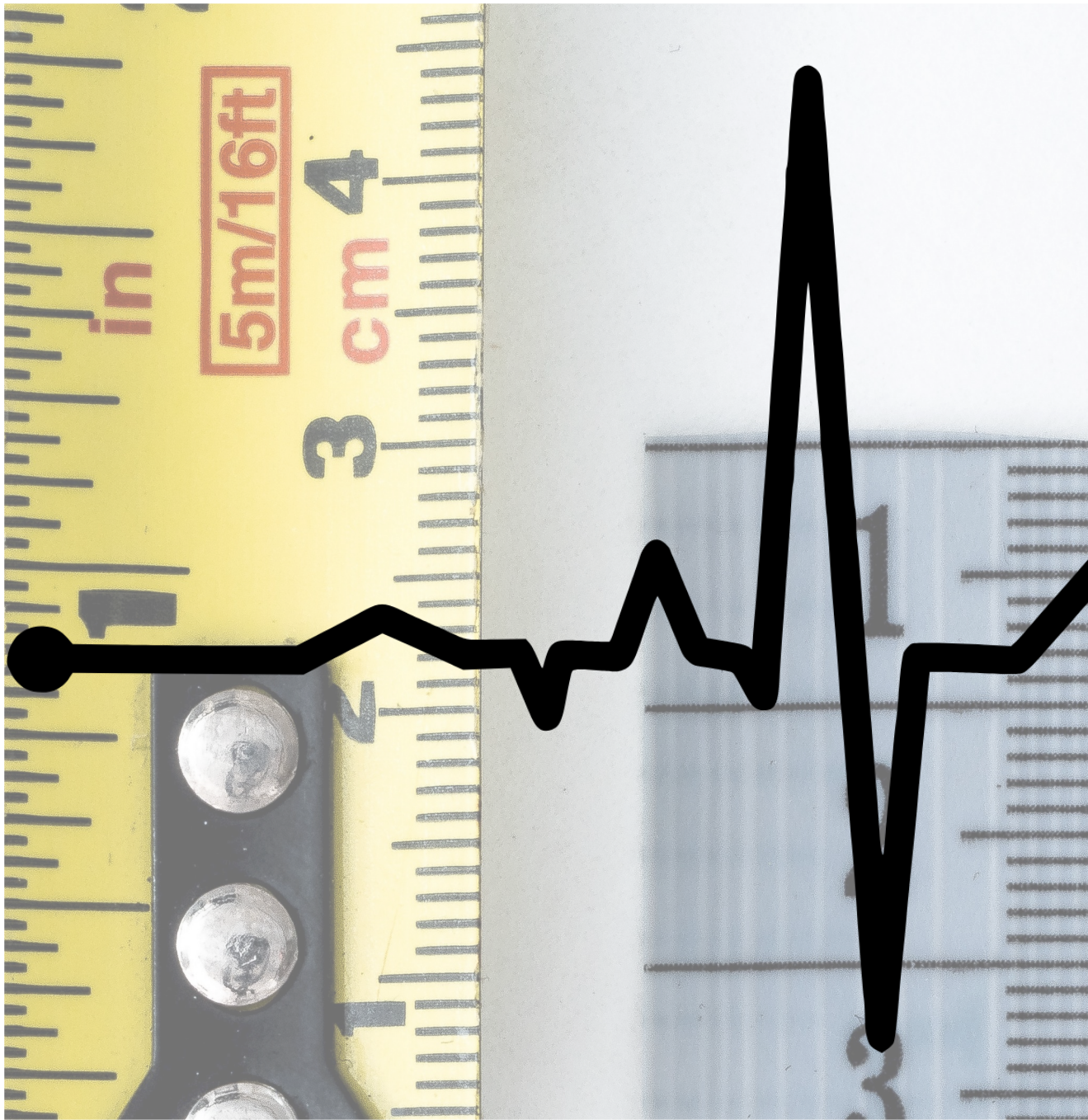

- Niche creation
  - Actors
    - Area of operations
  - Interactions
  - Contributions
  - Application

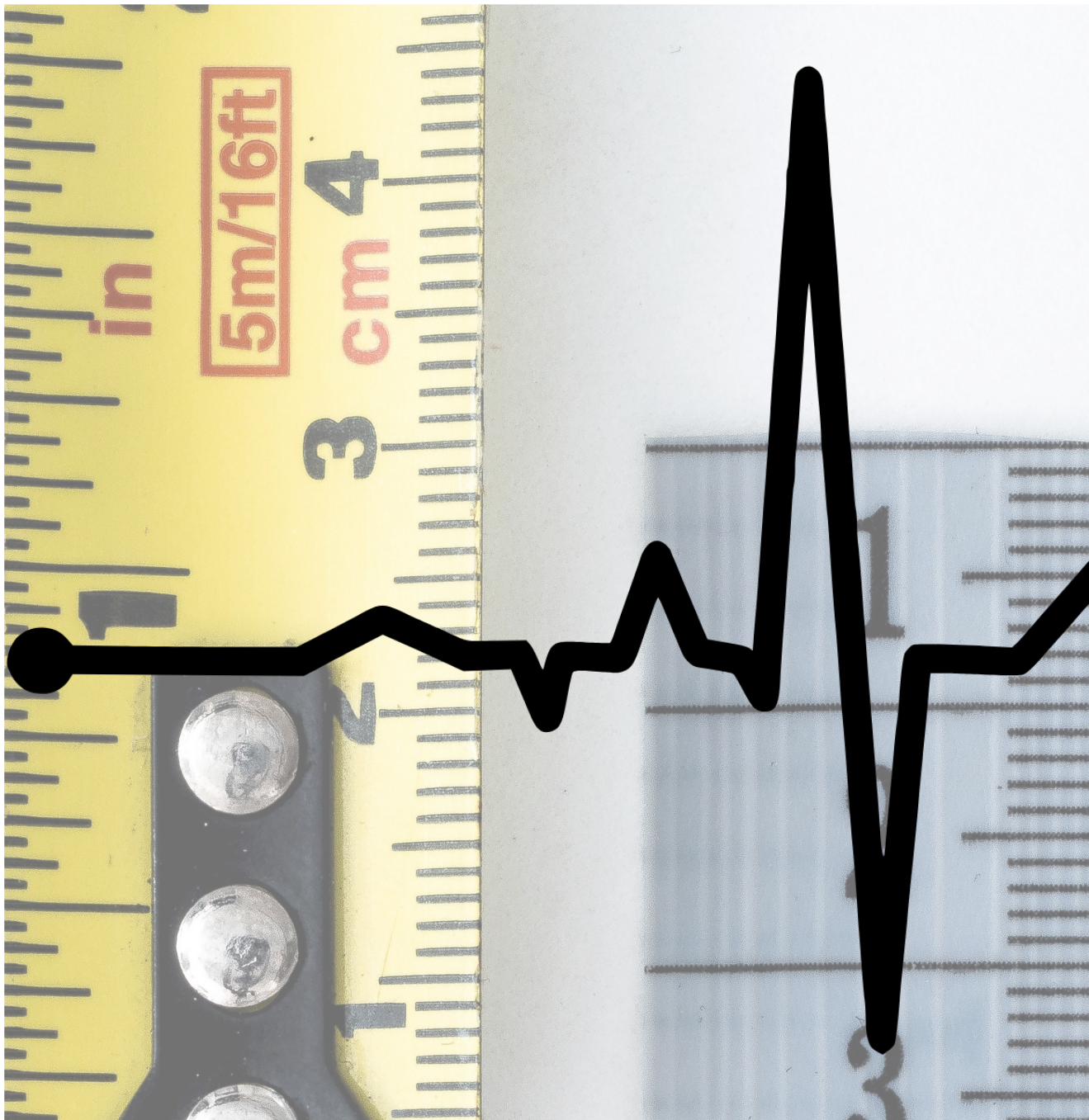

- Lessons learned

- Up front investments
- Knowledge about community
- Metric overflow
- Abstraction level
- Risk of overinterpretation



- Way forward
  - Start looking at the impact
  - Identify at stakeholders' performance objectives and elicit KPIs
  - Bridge with ecosystem health metrics
  - Follow up and revise ecosystem metrics iteratively

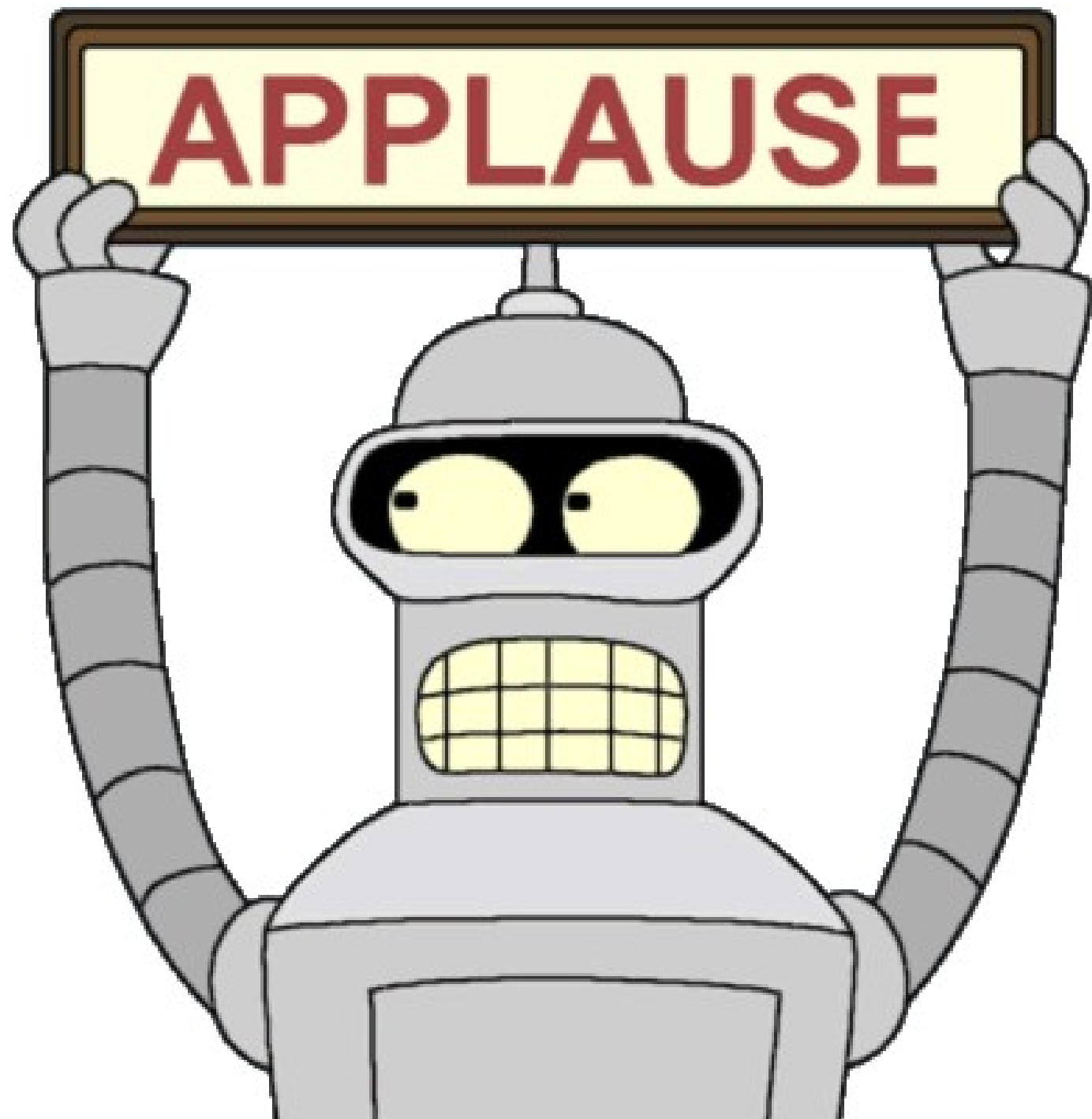

**APPLAUSE**



**LUND**  
UNIVERSITY